

LOCATION MAP



Live a peaceful life



**Structure**

R.C.C. framed Structure.

Flooring

Vitrified tiles in entire area.
Anti skid tiles in terrace, balcony and toilets.

Kitchen

Green Marble Top on Kadaph with S.S. sink & Glazed tiles upto 2.0 ft. high.

Doors

Main door and frame in teak wood and other doors flush doors with R.C.C. frame.

Windows

Aluminium sliding windows with M.S. grille.

Electrification

Concealed Wiring with sufficient points with circuit security through.
Power Point in Bedroom.
A.C. Point in Bedroom.
T.V. Point in drawing room and bedroom.
Telephone Point in drawing room and bedroom.

Toilets

Glazed Tiles upto 7ft. height in bathroom.

Painting

Water proof Cement Paint, Inner Wall : O.B.D.

Plumbing

Sanitary Fitting of standard quality.

Extra Charges :

Stamp duty, registration fees advocate fees and other incidental expenses shall be paid by purchaser.
Any extra work done shall be charged separately before execution.
Service Tax & Vat as applicable.

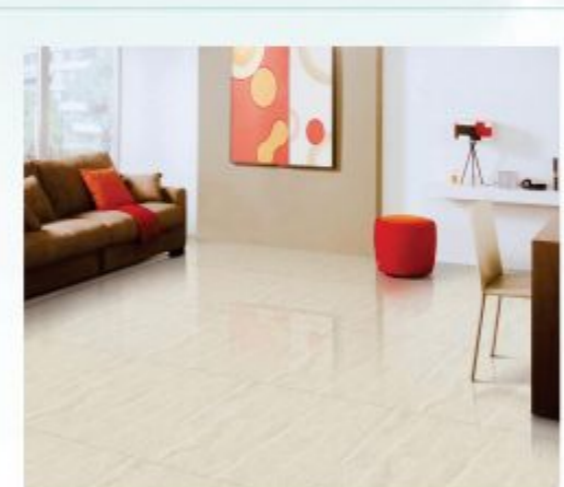

Shivam Builders and Colonizers is determined to its mission of imparting homes of choices for all segments of society, we succeeded to understand needs of habitants and win the faith of our respected customers in this small journey of home formation with emotions. We believe, In this modern era, when small cities like Chhindwara are also not far behind to mainstream cities, if it is concerned to live and enjoy luxurious amenities in home. We, at Shivam Builders are providing homes in vicinity of nature and well equipped with all modern amenities

Enjoy
Luxuries
to the fullest



gate choices of 2&1 BHK 1st floor on a 1 BHK Lavish ground floor

Ground Floor 1 BHK



First Floor Opt. 1 1 BHK

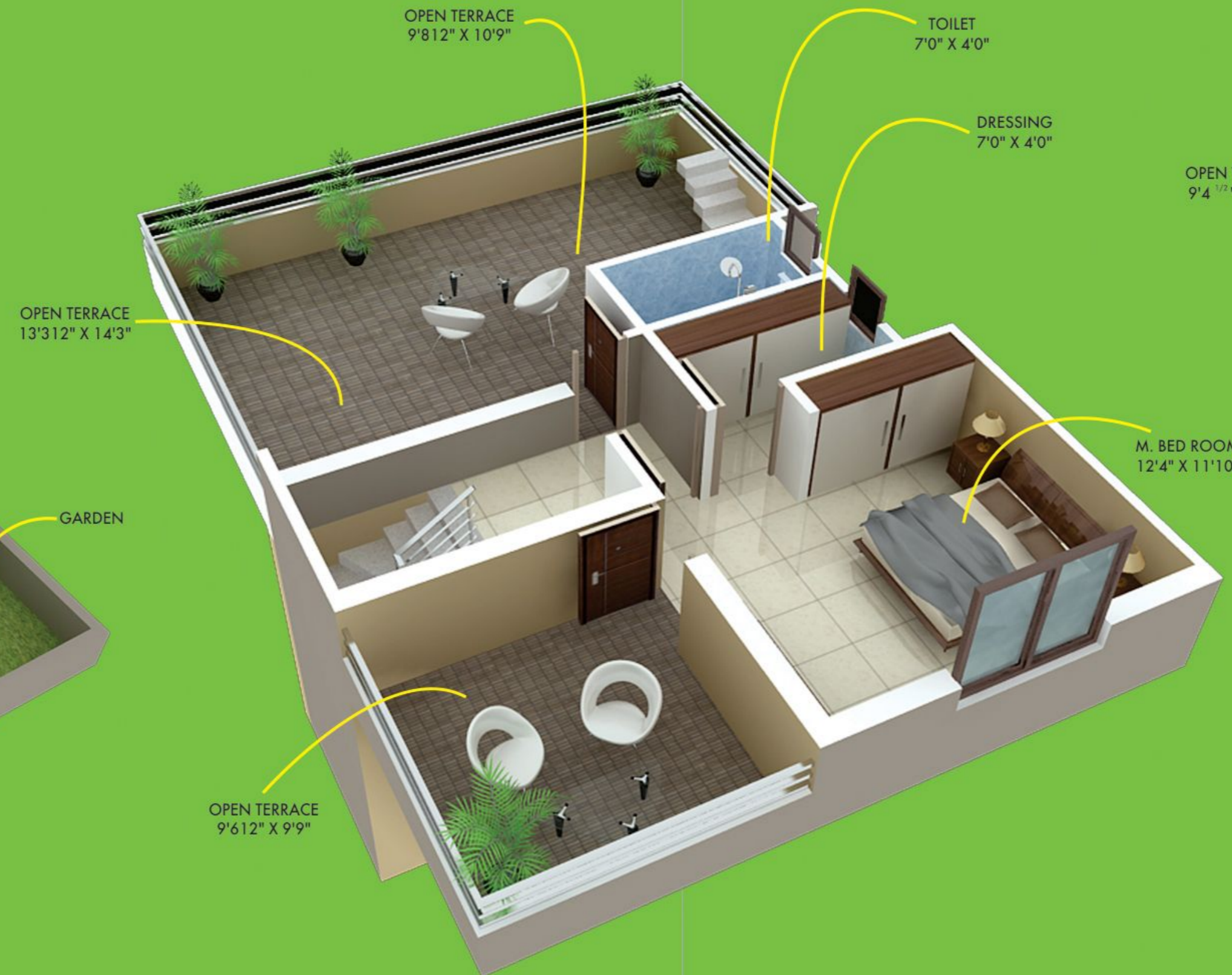

First Floor Opt. 2 2 BHK





MESTATE

Feel the
Serenity of Nature

The home with absolute soothing and serene environment and fulfills your needs of all requisite and lavish facilities.

Get choices of 2&1 BHK 1st floor on 1 BHK Lavish ground floor

Ground Floor

1 BHK



First Floor
Opt. 1

1 BHK



First Floor
Opt. 2

2 BHK

